



**RECORD OF TITLE  
UNDER LAND TRANSFER ACT 2017  
FREEHOLD  
Search Copy**



  
R.W. Muir  
Registrar-General  
of Land

**Identifier** SA57C/382  
**Land Registration District** South Auckland  
**Date Issued** 21 November 1995

**Prior References**  
SA31A/154

---

**Estate** Fee Simple  
**Area** 374.7741 hectares more or less  
**Legal Description** Lot 1 Deposited Plan South Auckland  
75436

**Registered Owners**  
Gleeson Quarries Huntly Limited

---

**Interests**

Excepting thereout all coal fireclay and other minerals in upon or under the said land (See CT SA1276/42)  
Subject to certain mining rights (in gross) in favour of Her Majesty the Queen for the term of 100 years from 1.7.1907 created by Lease 4092  
Subject to certain mining rights created by Transfer 245249 (affects part)  
Subject to a mining right over part created by Transfer S114058  
Subject to a right of way over part marked A on DPS 33185 created by Transfer B253837.2  
The easements created by Transfer B253837.2 are subject to Section 309 (1) (a) Local Government Act 1974  
Subject to a right of way over part marked A on DPS 71607 created by Transfer B344630.2 - 22.5.1996 at 9.23 am  
The easements created by Transfer B344630.2 are subject to Section 243 (a) Resource Management Act 1991  
Land Covenant in Easement Instrument 9249649.1 - 3.12.2012 at 10:02 am  
11298139.5 Mortgage to Bank of New Zealand - 3.12.2018 at 2:29 pm

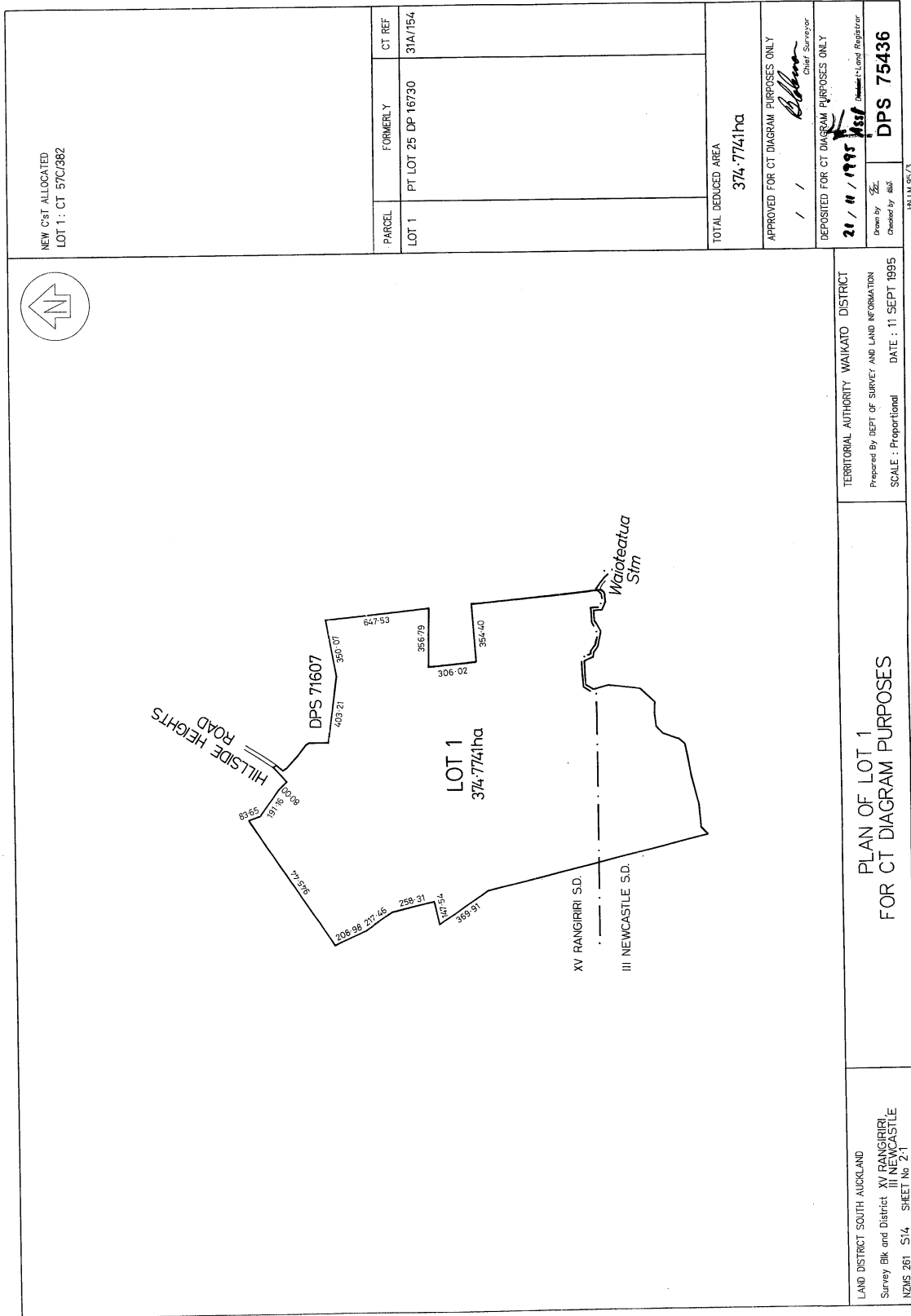

23 JUN 1996