MINUTES of a meeting of the Te Kauwhata Community Committee held at St John’s Ambulance Rooms, 4 Baird Avenue, Te Kauwhata on **WEDNESDAY, 1 MARCH 2023** commencing at **7.00pm**.

Present:

Adele Theron
Angela van de Munckhof
Estelle (Kahui) Jonathan
Ian Wrigley
Jeff Lyons
Jo Gurnell
Liz Tupuhi
Tim Hinton (Acting Chairperson)
Toni Grace
Marlene Raumati (councillor)

Attending:

Vishal Ramduny - Strategic Initiatives and Partnerships Manager
Karlene Rhind Senior Community Engagement Advisor and
Dominique Thurlow – Community and Development Funding Adviser
Jason Marconi - Economic Development Advisor
Tofeeq Ahmed – Programme Manager for Placemaking, Kainga Ora
Stuart McNab – Community member
Jillian McNab – Community member
Jan Sedgwick Community Member

I. APOLOGIES AND LEAVE OF ABSENCE

Resolved: (Jeff Lyons/Marlene Raumati)

THAT apologies from John Cunningham and Whitney Totorewa be received.

CARRIED

TKCC2303/I

2. CONFIRMATION OF STATUS OF AGENDA ITEMS

Resolved: (Ian Wrigley/ Angela van de Munckhof)

THAT the agenda for the meeting of the Te Kauwhata Community Committee held on Wednesday, 1 March 2023 be confirmed and all items therein be considered in open meeting.

It was noted that Cr Raumati suggested at the 1 February 2023 meeting that we add to the agenda regular reports/verbal updates from Ngaa Muka Development Trust. This would need to be done for the next meeting on 3 May 2023.

AND THAT all reports be received.

CARRIED

TKCC2303/2

PUBLIC FORUM

Jason Marconi and Tofeeq Ahmed provided a verbal overview of their thinking on a community identify strategy for Te Kauwhata. Tim Hinton noted that there is good diversity and great passion from the Community Committee to draw from. It was also noted that the strategy will help integrate the established Te Kauwhata township and the new Lakeside development. It was agreed that Estelle Jonathan and Adele Theron will work with Jason and Tofeeq on the strategy and that it will be a project that will be added to the Works and Issues report.

3. DISCLOSURES OF INTEREST

- Tim Hinton (as per disclosure of interest form)
- Jo Gurnell (being a member of the Community House)

4. CONFIRMATION OF MINUTES

Resolved: (Toni Grace/Adele Theron)

THAT the minutes of the meeting for the Te Kauwhata Community Committee, held on Wednesday, 1 February 2023 be confirmed as a true and correct record.

CARRIED

TKCC2303/3

5. ACTIONS

The actions were as per the minutes of the meeting held on Wednesday 1 February 2023.

6. REPORTS

Agenda Item 6.1. Appointment of Funding Representative

(Resolved: Toni Grace/Jo Gurnell)

Dominique Thurlow presented this report. Council is seeking to appoint a funding representative from the Committee. It was noted that this is generally the chairperson but that it doesn't need to be.

Training session will be provided as there are guidelines to be followed on what would be eligible for funding and how to assess and fund. The Committee funding representative will be responsible for the applications that come to Council's Democracy team, assess them, and recommend his/her view on whether this should be funded.

It was noted that an amendment is required to the process to correct the clause that when an organisation is applying for funding from the discretionary fund, the application does not go directly to the Chairperson. Dominique noted that this will be updated in the processes and documentation.

It was agreed that in the interim that John Cunningham be the funding representative but with the option to co-opt this to another member when he is back from leave.

THAT the Te Kauwhata Community Committee Chairperson be appointed as the interim funding representative for the 2022-2025 triennium unless delegated otherwise.

CARRIED

TKCC2303/4

Agenda Item 6.2. Discretionary Fund Report

(Resolved: Jo Gurnell/Adele Theron)

That the Te Kauwhata Community Committee:

- a. Receives the report for the Te Kauwhata Discretionary Fund and the North Waikato Development Funding report.**
- b. Re-allocate the \$5,000 which was initially allocated for the further development of playgrounds (as passed by resolution TKCCI902/04) for the development of the destination playground at the Te Kauwhata Domain.**
- c. Re-allocate the \$3,000 which was initially allocated for the further development of the playgrounds (as passed by resolution TKCC2002/04) back to the Te Kauwhata Community Committee Discretionary Fund budget.**

CARRIED

TKCC2303/5

Agenda Item 6.3. Te Kauwhata Works and Issues Report

Resolved: (Toni Grace/Marlene Raumati)

Project I: Dog exercise area

- Adele Theron alluded to the concept plan for the dog park including three identified picnic areas (one with a shade cloth) and a 'small dog' exercise area (see attachment 1 and attachment 2)
- Tim further advised that he met with Stephanie Loughnan (the Council's Parks and Reserves Technical Support Officer) at the Horotiu Dog Park during which it was confirmed that most of the equipment will be donated to the Te Kauwhata Dog Park. However, the equipment will need to be removed and re-sited by mid-March 2023. Tim advised that it will be a 'working bee' approach for the installation and will ensure that appropriate health and safety compliance requirements are met. Tim will finalise the

relocation of the equipment with Stephanie and suggested that the local Lions will assist with the recycling of this equipment. He expected that most of this to be completed (Phase 1&2, possibly 3) by the next meeting in May 2023.

Project 2: Walkway extending from Saleyard Road to Council Reserve at Blunt Road Walkway

- It was noted that the Council team is awaiting confirmation on the open drain consenting and the final consultant cost before proceeding with recommended alternative analysis.

Project 3: Safety Improvements on Main Road

- Two following changes were suggested on the final draft of the safety improvements on Main Road.
 1. THAT the speed cushions be removed from the safety improvement works
 2. THAT the pedestrian crossing be moved to opposite New World (if there are no Waka Kotahi compliance requirements in doing this).

The Committee also acknowledged that the Roding team's focus at the minute is on repairing our damaged roads from the cyclone and that implementation of the safety improvements to Main Road may be delayed because of this.

Project 4: Implementation of the Te Kauwhata Domain Plan

4.1. Te Kauwhata Domain walkway and fitness trail

3. It was noted that a multi-year (2+2years) Walkways Contract is being developed by Council and that the walkway projects in the contract will include Te Kauwhata Domain Walkway, Rotokauri Walkway and Wi Neera Walkway (Raglan) among others.
4. The Contract will be going out to the market in April 2023 when the walkways designs are completed.
5. Project Management consultants Octa have been engaged to complete the procurement plan, tender documents, and contracts.

4.2. Community Outdoor Stage

- Jo Gurnell suggested that it may make sense for the stage to be located adjacent to the playground (like the stage at Hamilton Gardens). Adele noted that part of the playground may need to be fenced off so this would need to be considered. Tim suggested a working group be tasked to work on this led by Jo.

4.3. Cameras

- Cr Raumati has met with Megan May (Council's Deputy GM for Service Delivery) at which it was confirmed that Te Kauwhata and Meremere will be the first communities to benefit from the camera roll out rather than waiting for a district-wide rollout. This was because there is already an LTP funding commitment for this project for Te Kauwhata and Meremere.

4.4. Domain Community Garden

- This is work in progress. Estelle advised that Whitney had referred the matter of the list of appropriate plant species to her as well.
- The Committee was reminded that there is an active Rongoa group (Toi Ako) in Te Kauwhata and it would be useful to link into them.
- Tim also indicated that, as a horticulturalist, he has good knowledge on appropriate plant species and can help with this.
- Whitney, Estelle, Jo, and Tim will be work on this project.

4.5. Mural adjacent to squash club

- Adele circulated a report (see attachment 3) showing some uplifting an inspirational panel design which can be used as examples.
- Adele, Tim, Estelle, and Jeff will work on this project and come back to the Committee with some firmed-up proposals.

THAT the Works and Issues report be received and the updates and actions from this meeting be noted for the next report.

CARRIED

TKCC2303/6

6.4 Councillor Report

Resolved: (Tim Hinton/ Angela van de Munckhof)

Cr Marlene Raumati provided the following verbal update:

- Noted that a lot of people in Hawkes Bay, Gisborne and Port Waikato have their lives upturned because of the cyclone.
- Advised that Council is proposing changes to how we manage traffic in our district by creating a new Traffic Bylaw. Consultation is open from 27 February to 27 March 2023.
- Advised that Council is also proposing changes to the Public Places Bylaw. Consultation is open from 27 February to 27 March 2023.
- A hearing on the Trade Waste and Wastewater by-law has been held.
- Advised that due to the impact of the cyclone on some of our communities and several of our roads, we need to be patient because Council is currently in recovery mode and hence priorities need to be re-ordered.
- That there was a very successful community and stakeholders' workshop on 23 February 2023 to discuss an emergency management plan for Te Kauwhata and Rangiriri. A group of coordinators have been appointed for Te Kauwhata, Meremere and Waerenga.
- That there was also a discussion with Kainga Ora and Council regarding development agreements. (Tim Hinton advised that he would get John Cunningham to lead a submission on this).

That the Te Kauwhata Community Committee receive the verbal councillor report.

CARRIED

TKCC2303/7

6.6. Chairpersons Report

Resolved: (Toni Grace/ Angela van de Munckhof)

- Tim Hinton, as the acting chairperson, provided the following verbal update:
- Thanked the Committee and Council staff for their leadership and commitment. Tim especially pointed out the great work being done by the Committee's project working groups. He noted that there is a great history of a functional committee who get things done. He is happy and proud to be a part of it.
- Suggested that the meeting structure needs to be reconsidered to allow for working groups to progress within the bounds of the meeting. He suggested that the Committee meetings should be from 7:00pm to 8:00pm and that 8:00pm-8:30pm be used for the project working groups to get together.
- Thanked Toni Grace for her contribution to the Committee and awarded her a gift on behalf of everyone after Toni gave a farewell speech.
- Acknowledged Jan Sedgwick for the gift she brought for Toni.

That the Te Kauwhata Community Committee receive the verbal Acting Chairperson's report.

CARRIED

TKCC2303/8

There being no further business the meeting was declared closed at 8:56 pm

Minutes approved and confirmed this 21st day of March 2023.

Tim Hinton

ACTING CHAIRPERSON

Te Kauwhata Dog Park Project

As part of the sub committee's tasks, we propose some changes to the overall dog park as represented below:

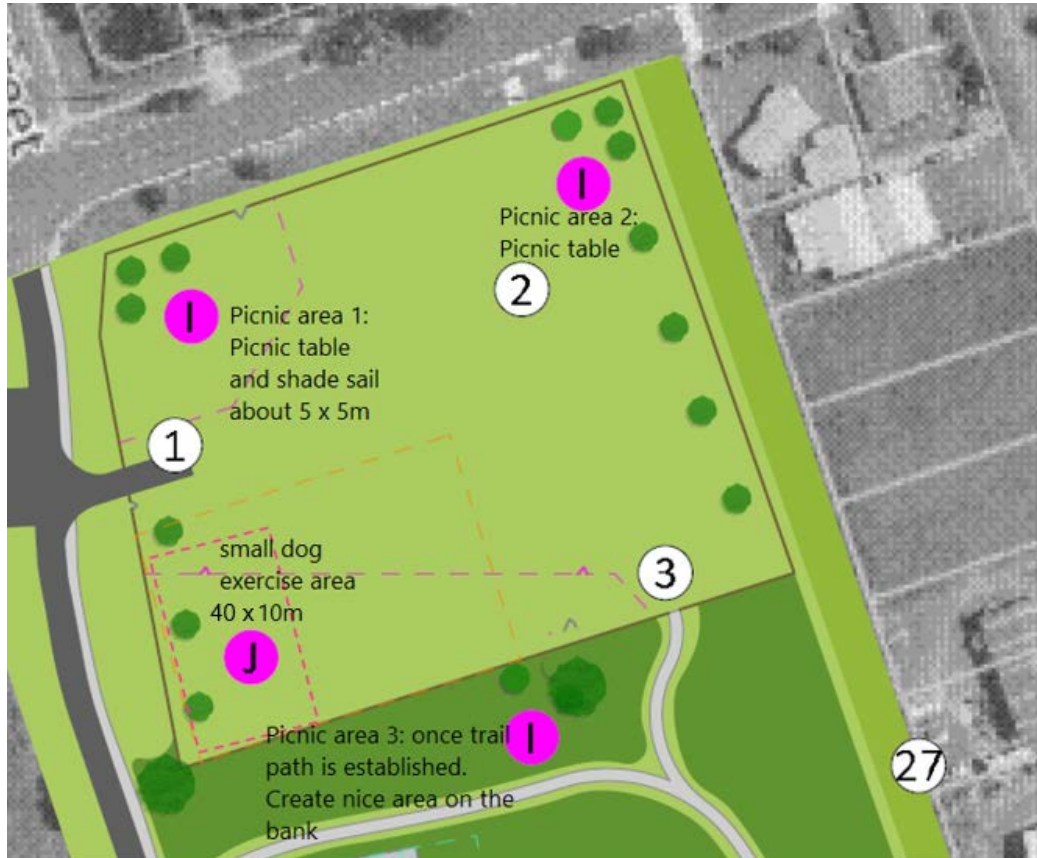

Phase 1: AGILITY EQUIPMENT

- Tim is checking out the agility equipment this week and sending photos to the rest of us. Then we will coordinate taking the stuff we agree will be cool to the dog park
- We will check to see if any of the equipment needs painting or fixing up. We might request support from the community on this and figure out how to source paint etc

Phase 2: PICNIC AREA 1

- We mapped out the area using paint on the ground
- We are sourcing a picnic table to place at picnic area 1
- I have contacted Sunshade and Shades Direct for quotes on shade sails which will cover the picnic table and look a bit like this below but with 3 wooden poles in the ground covering an area of 10m² and 15m² so we see what would work.
- We will source wooden poles and concrete and make a community project day of erecting the shade sail (once we figure out how to fund it)
- Tim will hopefully source some mulch for the areas under the trees and Jeff will source half rounds to keep mulch all in the area

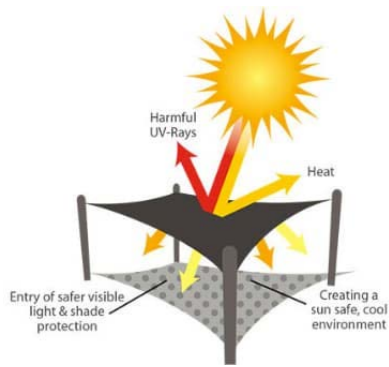

PHASE 3: Small dog fenced-off area

- We mapped out a small dog area in position J above measuring about 40 x 10m²
- We will look into fencing options for this area with a gate so mowing the lawn is still straightforward
- We need to feed back once we have explored fencing

PHASE 4: Picnic area 2

- Sourcing picnic table for this
- Tim will hopefully source some mulch for the areas under the trees and Jeff will source half rounds to keep mulch all in the area

PHASE 5:

- Walkway installed
- Gate to dog park to link to walking track installed
- Clearing of drain
- Removal of trees on the bank so the mural can be viewed
- Planting of trees at the far end by the squash court, so mural not obscured

Updated the domain drawing to represent these changes as well as the tennis/netball courts/ new position of the long jump and cricket nets.



LEGEND

- | | | |
|--|--|---|
| ① Double gated vehicle entrance to dog exercise area/ overflow parking | ⑭ Scout Hall | ⑳ Link from Mahi Road |
| ② Dog exercise area with water station and agility equipment | ⑮ Walkway/access to fields 3 & 4, gate relocated to top of walkway | ㉑ Planting of drain/low lying areas |
| ③ Link to fitness trail/walkway | ⑯ Rugby field 1 | ㉒ Community orchard/garden |
| ④ Rugby Club service area | ⑰ Cricket pitch and proposed long jump | ㉓ Link to Mahi Road with fruit trees |
| ⑤ Rugby Club | ⑱ Rugby field 2 | ㉔ Field drainage area to be planted |
| ⑥ Squash Club (to be extended) | ⑲ Cricket nets | ⑳ Fitness trail/walkway |
| ⑦ Bank area to be planted with natives | ㉑ Rugby field 3 | Ⓐ Ⓑ Proposed picnic area with BBQ |
| ⑧ Junior practice fields/event space | ㉒ Currently 5 year lease to equestrian group. Potential to be developed into sports fields | Ⓒ Ⓓ Ⓔ Proposed nature play area |
| ⑨ Field side seating | ㉓ Planting of low lying wetland areas, potential for walkway link to Lakeside | Ⓕ Ⓖ Ⓗ Proposed outdoor stage |
| ⑩ Carpark | ㉔ Link from Scott Road | Ⓖ Proposed dog park picnic areas |
| ⑪ Public toilets | ㉕ Link from St Andrews Place | Ⓙ Proposed 'small dog' exercise area |
| ⑫ Proposed destination playground | | Ⓚ Ⓛ Ⓜ Proposed multi-use courts including tennis and netball courts with possible running track around the courts |
| ⑬ Walkway/access to fields 1 & 2 | | |

Te Kauwhata Domain Mural Project

History of Te Kauwhata

Te Kauwhata refers to an ancient settlement on an island (Punikanae Island) in the middle of a lake in the area, Lake Waikare. Punikanae island has a silica sinter-depositing spring located on it. This is the only sinter depositing spring known outside the Taupo Volcanic Zone. Te Kauwhata (originally named Tā Kauwhata meaning empty storehouses back in the day) refers to the empty store houses (pātaka kai) that stood on this settlement, protecting food from pests on the mainland. The story goes that during the war, Māori would harvest kai (vegetables like kumara and potatoes) and bundle it up onto waka (boats) which would then get ferried across to Punikanae island to keep safe till winter. The little storehouses were on stilts and as the pests couldn't swim across the lake, pests could not destroy this valuable kai. In the winter, the Māori would row the wakas across the lake to fetch the kai again and returned to the maraes to feed the people. This kai sustained people during the war and were a lifeblood to the locals. Despite the battle of Rangiriri, Māori even fed the British this way during the war, so were the kind ways of the people.

If you look at the TK primary school and college emblems, you will see image of the storehouse.



The population is 2760 people as of June 2022. The township is surrounded by dairy farms, drystock holdings

and horticulture. Its newest building is its Waikato District Council library. Originally known as Wairangi, Te Kauwhata grew around a railway station built in the late 1870s.

The first home of the New Zealand wine industry, the Viticultural Research Station was the site of an experimental farm, growing Syrah, Chardonnay, Pinot Noir, Cabernet Sauvignon and Riesling grapes. International viticulturalist Romeo Bragato took over the running of this station in 1901 and five wines produced here won gold medals.

Just south of Te Kauwhata, is the site of one of the fiercest battles of the New Zealand land wars, fought at Rangiriri on 20 November 1863. Māori built an exceptionally strong paa there, and when the British forces attacked many men lost their lives. Part of the paa site is now a historic reserve. Te Kauwhata's natural features include Lake Waikare and the Whangamarino wetlands, a significant

environmental feature in the north Waikato. Located just north of the township, the Whangamarino wetlands area is the second largest peat bog and swamp complex in the North Island. The Whangamarino Wetland encompasses peat bog, swampland and river systems. The dominant vegetation is mānuka and wire rush, with moss and lichen species. Threatened plants include water milfoil, the swamp helmet orchid (*Anzybas carsei*), and clubmoss.

Threatened bird species, including the grey teal, the spotless crane, the North Island fernbird and around 25% of New Zealand's population of Australasian bitterns live in the wetland. Eighteen species of fish include the black mudfish.

In 1961 the lower Waikato–Waipā flood protection scheme caused water levels to drop by more than 1.5 metres. As part of wetland restoration, a weir was constructed on the Whangamarino River in 1989 to maintain minimum water levels. The Department of Conservation controls animal and plant pests, which include the highly invasive alligator weed. Established as a Ramsar site in 1989, this wetlands area has been developed further since the late 1990s. It is managed by the Department of Conservation it is the site of the first National Wetland Trail established in New Zealand. Te Kauwhata, a village of over

1,500 residents (1,617 – Census 2018). The township is surrounded by dairy farms, drystock holdings and horticulture. Its newest building is its Waikato District Council library. Originally known as Wairangi, Te Kauwhata grew around a railway station built in the late 1870s.

The first home of the New Zealand wine industry, the Viticultural Research Station was the site of an experimental farm, growing Syrah, Chardonnay, Pinot Noir, Cabernet Sauvignon and Riesling grapes. International viticulturalist Romeo Bragato took over the running of this station in 1901 and five wines produced here won gold medals.

Just south of Te Kauwhata, is the site of one of the fiercest battles of the New Zealand land

The TK Domain

A site where we have young and old across the community coming together to have picnics, attend events, play sports, play with their kids and walk their dogs. It's a community meeting spot where people from all walks of life and cultural backgrounds come together as friends and whānau.

In the past, the TK Domain was the site for the original War Memorial and people used to come together to sing/ dance and attend concerts, raffles and games evenings. Rugby was originally a source of recreation in Te Kauwhata since 1907 and was played at the TK

wars, fought at Rangiriri on 20 November 1863. Māori built an exceptionally strong paa there, and when the British forces attacked many men lost their lives. Part of the paa site is now a historic reserve.

Te Kauwhata's natural features include Lake Waikare and the Whangamarino wetlands, a significant environmental feature in the north Waikato. Located just north of the township, the Whangamarino wetlands area is the second largest peat bog and swamp complex in the North Island. Established as a Ramsar site in 1989, this wetlands area has been developed further since the late 1990s. It is managed by the Department of Conservation it is the site of the first National Wetland Trail established in New Zealand.

Domain from 1947 onwards. Back in those days, sheep would graze the Domain fields and keep them short.

Today the Domain plays host to a dog park, a rugby club, squash club, scouts hall, as well as a cricket pitch and training nets. In the future, the Domain will play host to Long jump and athletics club, multi-court facilities including a hockey pitch as well as netball and tennis courts, a kids playground, fitness track connecting Te Kauwhata and Lakeside, a running track and even a concert/ stage for cultural events and music festivals.

The TK Squash Club Mural project

- The mural project is designed to be erected on the Te Kauwhata Squash Court. It will be focused on capturing the essence of the TK Domain which has a history as a war memorial but is primarily used as a sports club and community meeting place for events and leisure.
- The mural will be visible from anyone driving down Mahi road or walking their dogs at the Te Kauwhata dog park.
- The Te Kauwhata Squash club currently has 2 courts but the vision in the future is to extend the club to have another 3 courts, making it a 5-court establishment.
- We would love to create a mural which really captures all the amazing images summarising the TK Domain up as a whole. If we can interlace some TK cultural, community and sporting history into this, it would be wonderful too.
- The TK Squash club engaged with Claire Dubosky previously and she designed a mural image representing just squash for the wall. Whilst it's totally beautiful, **we would like the mural to be**

more inclusive of the wider TK Domain community and tell the TK story beyond just the squash club.

- There will potentially be 12-15 panels to design. 6 panels for the existing courts (which should represent things already existing within the TK Domain) and 6-9 future panels which incorporate proposed changes we are working on for the TK Domain.
- There will be 15 panels to design and the first 6 need to be standalone as the next 6-9 panels will be years away.

PHASE 1		PHASE 2		
COURT 1 (exists)	COURT 2 (exists)	COURT 3 (proposed)	COURT 4 (proposed)	COURT 5 (proposed)
Panel 1	Panel 4	Panel 7	Panel 10	Panel 13
Panel 2	Panel 5	Panel 8	Panel 11	Panel 14
Panel 3	Panel 6	Panel 9	Panel 12	Panel 15

We would love to create a mural which tells the story of Te Kauwhata and the Domain. Perhaps the overall imagery can be agreed on and then cut into 'panels' to be created in phase 1 and phase 2 of this project. Phase 1 needs to be standalone as it will be some years before phase 2 takes effect.

After consultation with various parties including Frank Green and key representatives from Ngā Muka Development trust, the imagery below would be amazing to incorporate as part of an overall storyboard of Te Kauwhata...

The mural is to be uplifting and inspirational (so not too much war imagery please)...

HISTORY OF TK (part of phase 1 and or phase 2)	FAUNA AND FLORA of TK (part of phase 1 and or phase 2)	CURRENT DOMAIN ELEMENTS (phase 1 elements)	PROPOSED DOMAIN ELEMENTS (phase 2 elements)
<ul style="list-style-type: none"> • War Memorial – perhaps this can be represented with the Anzac day poppy • Māori caves – <i>these are located within the Whangamarino wetlands but due to the accumulation of silt, the caves are not visible right now. Mothers and children would hide here during the war</i> 	<ul style="list-style-type: none"> • Winelands – capturing some vine leaves and perhaps some wines? • Orchards • The wetlands • Agricultural and farming of kai • Mānuka and wire rush • Flax/ harakeke • Moss and lichen species • Threatened plants include water milfoil, the swamp 	<ul style="list-style-type: none"> • Rugby • Cricket • Squash • Scouts • Dog Park • Young and old of all cultures and parts of the community coming together as whānau 	<ul style="list-style-type: none"> • Long jump • Netball • Tennis • Playground • Fitness track • Running track • Concert/ stage • Athletics club • Hockey

<ul style="list-style-type: none"> • Singing with guitars, Taonga pūoro flutes and Purerehua musical instruments. For the Purerehua, the timber it is made of is native totara, and the carving is a symbol of the wind. 	<p>helmet orchid and clubmoss</p> <ul style="list-style-type: none"> • Sheep • Tuna from lake Waikare • Eels • Grey teal • Spotless crake North Island fernbird 		
---	--	--	--

Some look and feel ideas:



Next Steps

1. For Claire to look at this project and get some imagery and ideas together for a mural storyboard
2. For Claire to meet with key members of Ngā Muka Development trust, including the sculptor who is designing key images in the Lakeside project to discuss images he is using so the mural represents continuity with that project and is an extension of that project
3. For Claire to come back with a quote on phase 1 and phase 2 with timings and requirements needed to produce the work